

HTD 5M, HTD 8M, HTD 14M

Fekerman supply 5M, 8M, 14M timing pulleys

Pulleys bore type:

Stock bore / Finished bore type

Material selection:

Steel C45 / Aluminum

Surface treatment:

Black oxide, Zinc plating, Anodizing

Fekerman accept custom made pulleys as per the drawings and technology requirement.

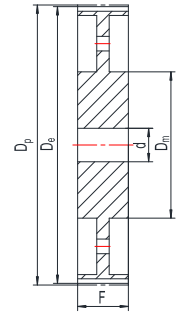
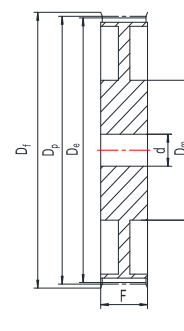
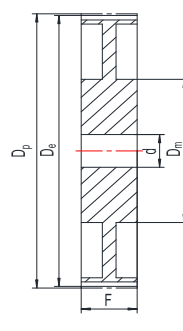
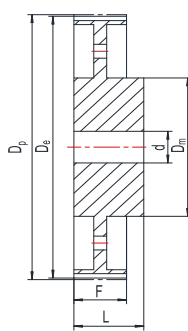
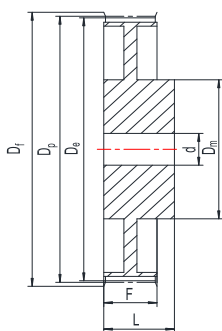
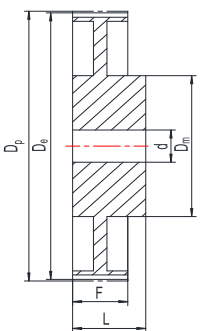
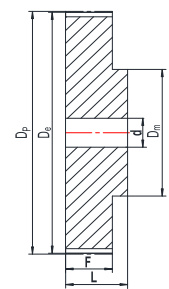
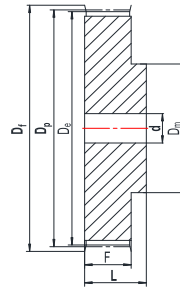
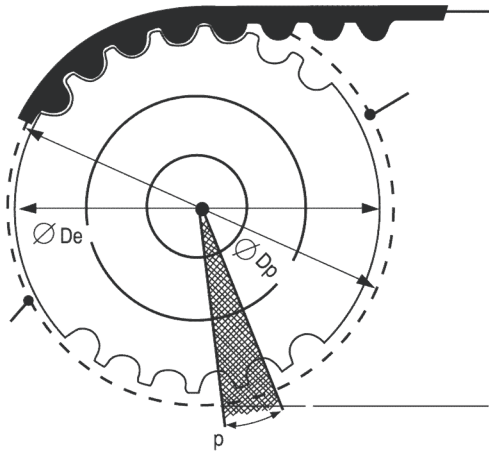

(3)

(3F)

(4)

(7)

(7F)

(8)

5M-09

For belt width 9mm

Part No.	Type	Mat.	Z	Dp	De	Df	Dm	F	L	d
12 5M-09	2F	St	12	19.10	17.96	23	12.5	14.5	20.0	6
14 5M-09	2F	St	14	22.28	21.14	25	13.5	14.5	20.0	6
15 5M-09	2F	St	15	23.87	22.73	28	15.5	14.5	20.0	6
16 5M-09	2F	St	16	25.46	24.32	28	16.5	14.5	20.0	6
18 5M-09	2F	St	18	28.65	27.51	32	20	14.5	20.0	6
20 5M-09	2F	St	20	31.83	30.69	36	23	14.5	22.5	6
21 5M-09	2F	St	21	33.42	32.28	38	24	14.5	22.5	6
22 5M-09	2F	St	22	35.01	33.87	38	25.5	14.5	22.5	6
24 5M-09	2F	St	24	38.20	37.06	42	27	14.5	22.5	6
26 5M-09	2F	St	26	41.38	40.24	44	30	14.5	22.5	6
28 5M-09	2F	St	28	44.56	43.42	48	30.5	14.5	22.5	6
30 5M-09	2F	St	30	47.75	46.60	51	35	14.5	22.5	6
32 5M-09	2F	St	32	50.93	49.79	54	38	14.5	22.5	8
36 5M-09	2F	St	36	57.30	56.16	60	38	14.5	22.5	8
40 5M-09	2F	St	40	63.66	62.52	71	38	14.5	22.5	8
44 5M-09	2	St	44	70.03	68.89	-	38	14.5	22.5	8
48 5M-09	2	St	48	76.39	75.25	-	45	14.5	22.5	8
60 5M-09	2	St	60	95.49	94.35	-	45	14.5	22.5	8
72 5M-09	2	St	72	114.59	113.45	-	45	14.5	22.5	8

5M-15

For belt width 15mm

Part No.	Type	Mat.	Z	Dp	De	Df	Dm	F	L	d
12 5M-15	2F	St	12	19.10	17.96	23	12.5	20.5	26	6
14 5M-15	2F	St	14	22.28	21.14	25	13.5	20.5	26	6
15 5M-15	2F	St	15	23.87	22.73	28	16	20.5	26	6
16 5M-15	2F	St	16	25.46	24.32	28	16.5	20.5	26	6
18 5M-15	2F	St	18	28.65	27.51	32	20	20.5	26	6
20 5M-15	2F	St	20	31.83	30.69	36	23	20.5	26	6
21 5M-15	2F	St	21	33.42	32.28	38	24	20.5	26	6
22 5M-15	2F	St	22	35.01	33.87	38	25.5	20.5	26	6
24 5M-15	2F	St	24	38.20	37.06	42	27	20.5	28	6
26 5M-15	2F	St	26	41.38	40.24	44	30	20.5	28	6
28 5M-15	2F	St	28	44.56	43.42	48	30.5	20.5	28	6
30 5M-15	2F	St	30	47.75	46.60	51	35	20.5	28	6
32 5M-15	2F	St	32	50.93	49.79	54	38	20.5	28	8
36 5M-15	2F	St	36	57.30	56.16	60	38	20.5	28	8
40 5M-15	2F	St	40	63.66	62.52	71	38	20.5	28	8
44 5M-15	2	St	44	70.03	68.89	-	38	20.5	30	8
48 5M-15	2	St	48	76.39	75.25	-	38	20.5	30	8
60 5M-15	2	St	60	95.49	94.35	-	50	20.5	30	8
72 5M-15	2	St	72	114.59	113.45	-	50	20.5	30	8

5M-25

For belt width 25mm

Part No.	Type	Mat.	Z	Dp	De	Df	Dm	F	L	d
12 5M-25	2F	St	12	19.10	17.96	23	12.5	30.5	36	6
14 5M-25	2F	St	14	22.28	21.14	25	13.5	30.5	36	6
15 5M-25	2F	St	15	23.87	22.73	28	16	30.5	36	6
16 5M-25	2F	St	16	25.46	24.32	28	16.5	30.5	36	6
18 5M-25	2F	St	18	28.65	27.51	32	20	30.5	36	6
20 5M-25	2F	St	20	31.83	30.69	36	23	30.5	36	6
21 5M-25	2F	St	21	33.42	32.28	38	24	30.5	38	6
22 5M-25	2F	St	22	35.01	33.87	38	25	30.5	38	6
24 5M-25	2F	St	24	38.20	37.06	42	27	30.5	38	6
26 5M-25	2F	St	26	41.38	40.24	44	30	30.5	38	6
28 5M-25	2F	St	28	44.56	43.42	48	30.5	30.5	38	6
30 5M-25	2F	St	30	47.75	46.60	51	35	30.5	38	6
32 5M-25	2F	St	32	50.93	49.79	54	38	30.5	38	8
36 5M-25	2F	St	36	57.30	56.16	60	38	30.5	38	8
40 5M-25	2F	St	40	63.66	62.52	71	38	30.5	38	8
44 5M-25	2	St	44	70.03	68.89	-	38	30.5	38	8
48 5M-25	2	St	48	76.39	75.25	-	38	30.5	38	8
60 5M-25	2	St	60	95.49	94.35	-	50	30.5	38	8
72 5M-25	2	St	72	114.59	113.45	-	50	30.5	38	8

8M-20

For belt width 20mm

Part No.	Type	Mat.	Z	Dp	De	Df	Dm	F	L	d
22 8M-20	2F	St	22	56.02	54.65	60	43	28	38	12
24 8M-20	2F	St	24	61.11	59.74	66	45	28	38	12
26 8M-20	2F	St	26	66.21	64.84	71	48	28	38	12
28 8M-20	2F	St	28	71.30	70.08	75	50	28	38	14
30 8M-20	2F	St	30	76.39	75.13	83	55	28	38	14
32 8M-20	2F	St	32	81.49	80.16	87	60	28	38	14
34 8M-20	2F	St	34	86.58	85.21	91	66	28	38	14
36 8M-20	2F	St	36	91.67	90.30	98	70	28	38	14
38 8M-20	2F	St	38	96.77	95.39	103	75	28	38	14
40 8M-20	2F	St	40	101.86	100.49	106	75	28	38	14
44 8M-20	2F	St	44	112.05	110.67	119	75	28	38	14
48 8M-20	2F	St	48	122.23	120.86	127	75	28	38	14
56 8M-20	3F	St	56	142.60	141.23	148	80	28	38	14
64 8M-20	3F	St	64	162.97	161.60	168	80	28	38	14
72 8M-20	3F	St	72	183.35	181.97	192	80	28	38	14
80 8M-20	3	St	80	203.72	202.35	-	90	28	38	14
90 8M-20	3	St	90	229.18	227.81	-	90	28	38	14
112 8M-20	4	St	112	285.21	283.83	-	90	28	38	18
144 8M-20	4	St	144	366.69	365.32	-	90	28	38	20
168 8M-20	4	St	168	427.81	426.44	-	100	28	38	20
192 8M-20	4	St	192	488.92	487.55	-	100	28	38	20

8M-30

For belt width 30mm

Part No.	Type	Mat.	Z	Dp	De	Df	Dm	F	L	d
22 8M-30	2F	St	22	56.02	54.65	60	43	38	48	12
24 8M-30	2F	St	24	61.11	59.74	66	45	38	48	12
26 8M-30	2F	St	26	66.21	64.84	71	48	38	48	12
28 8M-30	2F	St	28	71.30	70.08	75	50	38	48	14
30 8M-30	2F	St	30	76.39	75.13	83	55	38	48	14
32 8M-30	2F	St	32	81.49	80.16	87	60	38	48	14
34 8M-30	2F	St	34	86.58	85.21	91	66	38	48	14
36 8M-30	2F	St	36	91.67	90.30	98	70	38	48	14
38 8M-30	2F	St	38	96.77	95.39	103	75	38	48	14
40 8M-30	2F	St	40	101.86	100.49	106	75	38	48	14
44 8M-30	2F	St	44	112.05	110.67	119	75	38	48	14
48 8M-30	2F	St	48	122.23	120.86	127	75	38	48	14
56 8M-30	3F	St	56	142.60	141.23	148	90	38	48	14
64 8M-30	3F	St	64	162.97	161.60	168	90	38	48	14
72 8M-30	3F	St	72	183.35	181.97	192	95	38	48	14
80 8M-30	3	St	80	203.72	202.35	-	100	38	48	14
90 8M-30	3	St	90	229.18	227.81	-	100	38	48	14
112 8M-30	4	St	112	285.21	283.83	-	100	38	48	18
144 8M-30	4	St	144	366.69	365.32	-	100	38	48	20
168 8M-30	4	St	168	427.81	426.44	-	100	38	48	20
192 8M-30	4	St	192	488.92	487.55	-	100	38	48	20

8M-50

For belt width 50mm

Part No.	Type	Mat.	Z	Dp	De	Df	Dm	F	L	d
22 8M-50	2F	St	22	56.02	54.65	60	43	60	70	12
24 8M-50	2F	St	24	61.11	59.74	66	45	60	70	12
26 8M-50	2F	St	26	66.21	64.84	71	48	60	70	12
28 8M-50	2F	St	28	71.30	70.08	75	50	60	70	14
30 8M-50	2F	St	30	76.39	75.13	83	55	60	70	14
32 8M-50	2F	St	32	81.49	80.16	87	60	60	70	14
34 8M-50	2F	St	34	86.58	85.21	91	66	60	70	14
36 8M-50	2F	St	36	91.67	90.30	98	70	60	70	14
38 8M-50	2F	St	38	96.77	95.39	103	75	60	70	14
40 8M-50	2F	St	40	101.86	100.49	106	75	60	70	14
44 8M-50	2F	St	44	112.05	110.67	119	75	60	70	14
48 8M-50	2F	St	48	122.23	120.86	127	75	60	70	14
56 8M-50	7F	St	56	142.60	141.23	148	90	60	70	18
64 8M-50	7F	St	64	162.97	161.60	168	100	60	60	18
72 8M-50	7F	St	72	183.35	181.97	192	100	60	60	18
80 8M-50	7	St	80	203.72	202.35	-	110	60	60	18
90 8M-50	7	St	90	229.18	227.81	-	110	60	60	18
112 8M-50	8	St	112	285.21	283.83	-	110	60	60	18
144 8M-50	8	St	144	366.69	365.32	-	110	60	60	20
168 8M-50	8	St	168	427.81	426.44	-	120	60	60	20
192 8M-50	8	St	192	488.92	487.55	-	130	60	60	20

8M-85

For belt width 85mm

Part No.	Type	Mat.	Z	Dp	De	Df	Dm	F	L	d
22 8M-85	2F	St	22	56.02	54.65	60	43	95	105	12
24 8M-85	2F	St	24	61.11	59.74	66	45	95	105	12
26 8M-85	2F	St	26	66.21	64.84	71	48	95	105	12
28 8M-85	2F	St	28	71.30	70.08	75	50	95	105	14
30 8M-85	2F	St	30	76.39	75.13	83	55	95	105	14
32 8M-85	2F	St	32	81.49	80.16	87	60	95	105	14
34 8M-85	2F	St	34	86.58	85.21	91	66	95	105	14
36 8M-85	2F	St	36	91.67	90.30	98	70	95	105	14
38 8M-85	2F	St	38	96.77	95.39	103	75	95	105	14
40 8M-85	2F	St	40	101.86	100.49	106	75	95	105	14
44 8M-85	2F	St	44	112.05	110.67	119	75	95	105	14
48 8M-85	2F	St	48	122.23	120.86	127	75	95	105	14
56 8M-85	2F	St	56	142.60	141.23	148	80	95	105	18
64 8M-85	7F	St	64	162.97	161.60	168	100	95	95	18
72 8M-85	7F	St	72	183.35	181.97	192	110	95	95	18
80 8M-85	8	St	80	203.72	202.35	-	110	95	95	20
90 8M-85	8	St	90	229.18	227.81	-	110	95	95	20
112 8M-85	8	St	112	285.21	283.83	-	110	95	95	24
144 8M-85	8	St	144	366.69	365.32	-	120	95	95	24
168 8M-85	8	St	168	427.81	426.44	-	120	95	95	24
192 8M-85	8	St	192	488.92	487.55	-	130	95	95	24

14M-40

For belt width 40mm

Part No.	Type	Mat.	Z	Dp	De	Df	Dm	F	L	d
28 14M-40	2F	St	28	124.78	122.12	127	100	54	69	24
30 14M-40	2F	St	30	133.69	130.99	138	100	54	69	24
32 14M-40	2F	St	32	142.60	139.88	154	100	54	69	24
34 14M-40	2F	St	34	151.52	148.79	160	100	54	69	24
36 14M-40	2F	St	36	160.43	157.68	168	100	54	69	24
38 14M-40	2F	St	38	169.34	166.60	183	120	54	69	24
40 14M-40	2F	St	40	178.25	175.49	188	120	54	69	24
44 14M-40	2F	St	44	196.08	193.28	211	120	54	69	24
48 14M-40	3F	St	48	213.90	211.11	226	135	54	69	24
56 14M-40	3F	St	56	249.55	246.76	256	135	54	69	28
64 14M-40	3F	St	64	285.21	282.41	296	135	54	69	28
72 14M-40	4	St	72	320.86	318.06	-	135	54	69	28
80 14M-40	4	St	80	356.51	353.71	-	135	54	69	28
90 14M-40	4	St	90	401.07	398.28	-	135	54	69	28
112 14M-40	4	St	112	499.11	496.32	-	135	54	69	28
144 14M-40	4	St	144	641.71	638.92	-	135	54	69	28
168 14M-40	4	St	168	748.66	745.87	-	135	54	69	28
192 14M-40	4	St	192	855.62	852.82	-	135	54	69	28

14M-55

For belt width 55mm

Part No.	Type	Mat.	Z	Dp	De	Df	Dm	F	L	d
28 14M-55	2F	St	28	124.78	122.12	127	100	70	85	24
30 14M-55	2F	St	30	133.69	130.99	138	100	70	85	24
32 14M-55	2F	St	32	142.60	139.88	154	100	70	85	24
34 14M-55	2F	St	34	151.52	148.79	160	100	70	85	24
36 14M-55	2F	St	36	160.43	157.68	168	100	70	85	24
38 14M-55	2F	St	38	169.34	166.60	183	120	70	85	24
40 14M-55	2F	St	40	178.25	175.49	188	120	70	85	24
44 14M-55	2F	St	44	196.08	193.28	211	120	70	85	24
48 14M-55	7F	St	48	213.90	211.11	226	135	70	70	24
56 14M-55	7F	St	56	249.55	246.76	256	135	70	70	28
64 14M-55	7F	St	64	285.21	282.41	296	135	70	70	28
72 14M-55	8	GG	72	320.86	318.06	-	135	70	70	28
80 14M-55	8	GG	80	356.51	353.71	-	135	70	70	28
90 14M-55	8	GG	90	401.07	398.28	-	135	70	70	28
112 14M-55	8	GG	112	499.11	496.32	-	135	70	70	28
144 14M-55	8	GG	144	641.71	638.92	-	135	70	70	28
168 14M-55	8	GG	168	748.66	745.87	-	135	70	70	28
192 14M-55	8	GG	192	855.62	852.82	-	135	70	70	28

14M-85 For belt width 85mm

Part No.	Type	Mat.	Z	Dp	De	Df	Dm	F	L	d
28 14M-85	2F	St	28	124.78	122.12	127	100	102	117	24
30 14M-85	2F	St	30	133.69	130.99	138	100	102	117	24
32 14M-85	2F	St	32	142.60	139.88	154	100	102	117	24
34 14M-85	2F	St	34	151.52	148.79	160	100	102	117	24
36 14M-85	2F	St	36	160.43	157.68	168	100	102	117	32
38 14M-85	2F	St	38	169.34	166.60	183	120	102	117	32
40 14M-85	2F	St	40	178.25	175.49	188	135	102	117	32
44 14M-85	2F	St	44	196.08	193.28	211	135	102	117	32
48 14M-85	2F	St	48	213.90	211.11	226	135	102	117	32
56 14M-85	7F	St	56	249.55	246.76	256	150	102	102	32
64 14M-85	7F	St	64	285.21	282.41	296	150	102	102	32
72 14M-85	8	GG	72	320.86	318.06	-	150	102	102	32
80 14M-85	8	GG	80	356.51	353.71	-	150	102	102	32
90 14M-85	8	GG	90	401.07	398.28	-	150	102	102	32
112 14M-85	8	GG	112	499.11	496.32	-	150	102	102	32
144 14M-85	8	GG	144	641.71	638.92	-	150	102	102	32
168 14M-85	8	GG	168	748.66	745.87	-	150	102	102	32
192 14M-85	8	GG	192	855.62	852.82	-	165	102	102	32

14M-115 For belt width 115mm

Part No.	Type	Mat.	Z	Dp	De	Df	Dm	F	L	d
28 14M-115	2F	St	28	124.78	122.12	127	100	133	148	32
30 14M-115	2F	St	30	133.69	130.99	138	100	133	148	32
32 14M-115	2F	St	32	142.60	139.88	154	100	133	148	32
34 14M-115	2F	St	34	151.52	148.79	160	100	133	148	32
36 14M-115	2F	St	36	160.43	157.68	168	120	133	148	32
38 14M-115	2F	St	38	169.34	166.60	183	120	133	148	32
40 14M-115	2F	St	40	178.25	175.49	188	135	133	148	32
44 14M-115	2F	St	44	196.08	193.28	211	140	133	148	32
48 14M-115	2F	St	48	213.90	211.11	226	150	133	148	32
56 14M-115	2F	St	56	249.55	246.76	256	150	133	148	32
64 14M-115	7F	St	64	285.21	282.41	296	150	133	148	32
72 14M-115	8	GG	72	320.86	318.06	-	150	133	148	32
80 14M-115	8	GG	80	356.51	353.71	-	150	133	148	32
90 14M-115	8	GG	90	401.07	398.28	-	150	133	148	32
112 14M-115	8	GG	112	499.11	496.32	-	150	133	148	32
144 14M-115	8	GG	144	641.71	638.92	-	165	133	148	32
168 14M-115	8	GG	168	748.66	745.87	-	165	133	148	32
192 14M-115	8	GG	192	855.62	852.82	-	165	133	148	32

14M-170 For belt width 170mm

Part No.	Type	Mat.	Z	Dp	De	Df	Dm	F	L	d
28 14M-170	2F	St	28	124.78	122.12	127	100	187	202	32
30 14M-170	2F	St	30	133.69	130.99	138	100	187	202	32
32 14M-170	2F	St	32	142.60	139.88	154	100	187	202	32
34 14M-170	2F	St	34	151.52	148.79	160	100	187	202	32
36 14M-170	2F	St	36	160.43	157.68	168	120	187	202	32
38 14M-170	2F	St	38	169.34	166.60	183	135	187	202	32
40 14M-170	2F	St	40	178.25	175.49	188	140	187	202	32
44 14M-170	2F	St	44	196.08	193.28	211	160	187	202	32
48 14M-170	2F	St	48	213.90	211.11	226	160	187	202	32
56 14M-170	2F	St	56	249.55	246.76	256	160	187	202	32
64 14M-170	2F	St	64	285.21	282.41	296	180	187	202	32
72 14M-170	7	St	72	320.86	318.06	-	180	187	187	32
80 14M-170	7	St	80	356.51	353.71	-	180	187	187	32
90 14M-170	8	GG	90	401.07	398.28	-	180	187	187	38
112 14M-170	8	GG	112	499.11	496.32	-	200	187	187	38
144 14M-170	8	GG	144	641.71	638.92	-	220	187	187	38
168 14M-170	8	GG	168	748.66	745.87	-	220	187	187	38
192 14M-170	8	GG	192	855.62	852.82	-	220	187	187	38

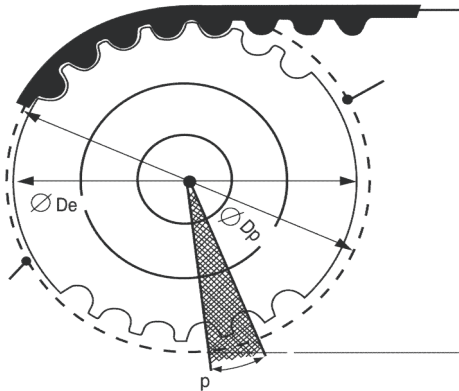

HTD 8M, HTD 14M

Fekerman supply 8M, 14M timing pulleys
Pulleys bore type: Taper bushed bore

Material:
Steel C45 / Aluminum
Surface treatment:
Black oxide, Anodizing, Chromium plating.

Fekerman accept custom made pulleys as per the drawings and technology requirement.

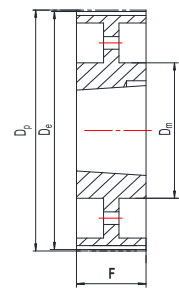
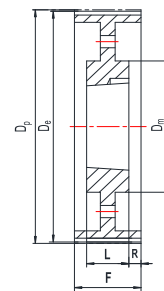
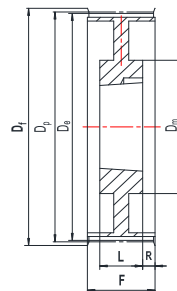
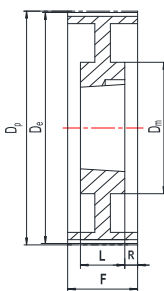
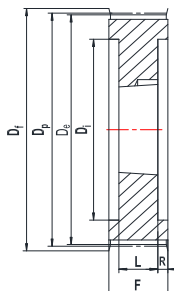
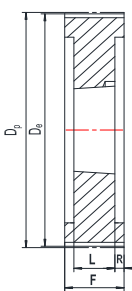
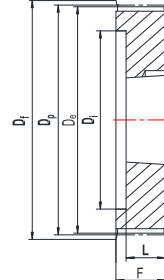
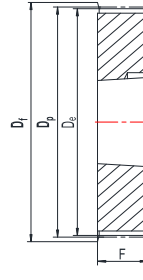
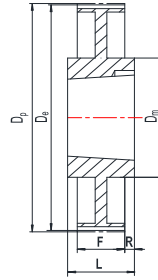
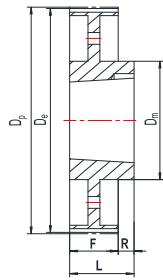
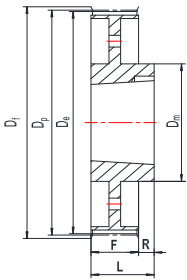
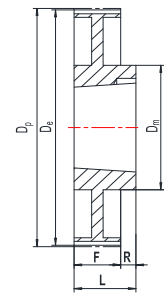
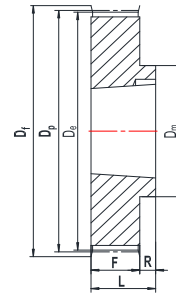

8M-20

for belt width 20mm

Pulleys with taper bushed bore

Part No.	Type	Bush	Z	Dp	De	Df	Dm	F	L	R
TB22 8M-20	16F	1008	22	56.02	54.65	60	–	28	22	6
TB24 8M-20	16F	1108	24	61.11	59.75	66	–	28	22	6
TB26 8M-20	16F	1108	26	66.21	64.84	71	–	28	22	6
TB28 8M-20	16F	1108	28	71.30	70.08	75	–	28	22	6
TB30 8M-20	16F	1108	30	76.39	75.13	83	–	28	22	6
TB32 80-20	16F	1610	32	81.49	80.16	87	–	28	25	3
TB34 8M-20	16F	1610	34	86.58	85.21	91	–	28	25	3
TB36 8M-20	16F	1610	36	91.67	90.30	98	–	28	25	3
TB38 8M-20	16F	1610	38	96.77	95.39	103	–	28	25	3
TB40 8M-20	16F	1610	40	101.86	100.49	106	–	28	25	3
TB44 8M-20	10F	2012	44	112.05	110.67	119	92	28	32	4
TB48 8M-20	10F	2012	48	122.23	120.86	127	96	28	32	4
TB56 8M-20	10F	2012	56	142.60	141.23	148	110	28	32	4
TB64 8M-20	11F	2012	64	162.97	161.60	168	110	28	32	4
TB72 8M-20	11F	2012	72	183.35	181.97	192	110	28	32	4
TB80 8M-20	11	2012	80	203.72	202.35	–	110	28	32	4
TB90 8M-20	11	2012	90	229.18	227.81	–	110	28	32	4

8M-30

for belt width 30mm

Pulleys with taper bushed bore

Part No.	Type	Bush	Z	Dp	De	Df	Dm	F	L	R
TB22 8M-30	16F	1008	22	56.02	54.65	60	–	38	22	16
TB24 8M-30	16F	1108	24	61.11	59.75	66	–	38	22	16
TB26 8M-30	16F	1108	26	66.21	64.84	71	–	38	22	16
TB28 8M-30	16F	1210	28	71.30	70.08	75	–	38	25	13
TB30 8M-30	15F	1615	30	76.39	75.13	83	–	38	38	–
TB32 80-30	15F	1615	32	81.49	80.16	87	–	38	38	–
TB34 8M-30	15F	1615	34	86.58	85.21	91	–	38	38	–
TB36 8M-30	15F	1615	36	91.67	90.30	98	–	38	38	–
TB38 8M-30	15F	1615	38	96.77	95.39	103	–	38	38	–
TB40 8M-30	15F	1615	40	101.86	100.49	106	–	38	38	–
TB44 8M-30	18F	2012	44	112.05	110.67	119	–	38	32	3
TB48 8M-30	18F	2012	48	122.23	120.86	127	–	38	32	3
TB56 8M-30	18F	2012	56	142.60	141.23	148	–	38	32	3
TB64 8M-30	10F	2517	64	162.97	161.60	168	125	38	45	7
TB72 8M-30	11F	2517	72	183.35	181.97	192	125	38	45	7
TB80 8M-30	11	2517	80	203.72	202.35	–	125	38	45	7
TB90 8M-30	11	2517	90	229.18	227.81	–	125	38	45	7
TB112 8M-30	12	2517	112	285.21	283.83	–	125	38	45	7
TB144 8M-30	12	2517	144	366.69	365.32	–	125	38	45	7

8M-50

for belt width 50mm

Pulleys with taper bushed bore

Part No.	Type	Bush	Z	Dp	De	Df	Dm	F	L	R
TB28 8M-50	16F	1210	28	71.30	70.08	75	–	60	25	35
TB30 8M-50	16F	1615	30	76.39	75.13	83	–	60	38	22
TB32 80-50	16F	1615	32	81.49	80.16	87	–	60	38	22
TB34 8M-50	16F	1615	34	86.58	85.21	91	–	60	38	22
TB36 8M-50	16F	1615	36	91.67	90.30	98	–	60	38	22
TB38 8M-50	16F	1615	38	96.77	95.39	103	–	60	38	22
TB40 8M-50	18F	2012	40	101.86	100.49	106	–	60	32	14
TB44 8M-50	18F	2012	44	112.05	110.67	119	–	60	32	14
TB48 8M-50	18F	2012	48	122.23	120.86	127	–	60	32	14
TB56 8M-50	18F	2517	56	142.60	141.23	148	–	60	45	7.5
TB64 8M-50	18F	2517	64	162.97	161.60	168	–	60	45	7.5
TB72 8M-50	19F	2517	72	183.35	181.97	192	125	60	45	7.5
TB80 8M-50	18	3020	80	203.72	202.35	–	–	60	51	4.5
TB90 8M-50	19	3020	90	229.18	227.81	–	160	60	51	4.5
TB112 8M-50	19	3020	112	285.21	283.83	–	170	60	51	4.5
TB144 8M-50	20	3020	144	366.69	365.32	–	170	60	51	4.5
TB168 8M-50	14	3525	168	427.81	426.44	–	198	60	65	2.5
TB192 8M-50	14	3525	192	488.92	487.55	–	198	60	65	2.5

8M-85

for belt width 85mm

Pulleys with taper bushed bore

Part No.	Type	Bush	Z	Dp	De	Df	Dm	F	L	R
TB34 8M-85	18F	1615	34	86.58	85.21	91	–	95	38	28.5
TB36 8M-85	18F	1615	36	91.67	90.30	98	–	95	38	28.5
TB38 8M-85	18F	1615	38	96.77	95.39	103	–	95	38	28.5
TB40 8M-85	18F	2012	40	101.86	100.49	106	–	95	32	31.5
TB44 8M-85	18F	2012	44	112.05	110.67	119	–	95	32	31.5
TB48 8M-85	18F	2517	48	122.23	120.86	127	–	95	45	25
TB56 8M-85	18F	2517	56	142.60	141.23	148	–	95	45	25
TB64 8M-85	18F	2517	64	162.97	161.60	168	–	95	45	25
TB72 8M-85	18F	3020	72	183.35	181.97	192	–	95	51	22
TB80 8M-85	18	3020	80	203.72	202.35	–	–	95	51	22
TB90 8M-85	19	3020	90	229.18	227.81	–	170	95	51	22
TB112 8M-85	19	3020	112	285.21	283.83	–	170	95	51	22
TB144 8M-85	20	3525	144	366.69	365.32	–	198	95	65	15
TB168 8M-85	20	3525	168	427.81	426.44	–	198	95	65	15
TB192 8M-85	20	3525	192	488.92	487.55	–	198	95	65	15

14M-40

for belt width 40mm

Pulleys with taper bushed bore

Part No.	Type	Bush	Z	Dp	De	Df	Dm	F	L	R
TB28 14M-40	18F	2012	28	124.78	122.12	127	–	54	32	11
TB30 14M-40	18F	2012	30	133.69	130.99	138	–	54	32	11
TB32 14M-40	18F	2012	32	142.60	139.88	154	–	54	32	11
TB34 14M-40	18F	2517	34	151.52	148.79	160	–	54	45	4.5
TB36 14M-40	18F	2517	36	160.43	157.68	168	–	54	45	4.5
TB38 14M-40	18F	2517	38	169.34	166.60	183	–	54	45	4.5
TB40 14M-40	18F	2517	40	178.25	175.49	188	–	54	45	4.5
TB44 14M-40	18F	3020	44	196.08	193.28	211	–	54	51	1.5
TB48 14M-40	18F	3020	48	213.90	211.11	226	–	54	51	1.5
TB56 14M-40	18F	3020	56	249.55	246.76	256	170	54	51	1.5
TB64 14M-40	19F	3020	64	285.21	282.41	296	170	54	51	1.5
TB72 14M-40	19	3020	72	320.86	318.06	–	170	54	51	1.5
TB80 14M-40	20	3020	80	356.51	353.71	–	170	54	51	1.5
TB90 14M-40	20	3020	90	401.07	398.28	–	170	54	51	1.5
TB112 14M-40	20	3020	112	499.11	496.32	–	170	54	51	1.5
TB144 14M-40	20	3020	144	641.71	638.92	–	170	54	51	1.5
TB168 14M-40	20	3020	168	748.66	745.87	–	170	54	51	1.5
TB192 14M-40	20	3020	192	855.62	852.82	–	170	54	51	1.5

14M-55

for belt width 55mm

Pulleys with taper bushed bore

Part No.	Type	Bush	Z	Dp	De	Df	Dm	F	L	R
TB28 14M-55	18F	2012	28	124.78	122.12	127	–	70	32	19
TB30 14M-55	18F	2517	30	133.69	130.99	138	–	70	45	12.5
TB32 14M-55	18F	2517	32	142.60	139.88	154	–	70	45	12.5
TB34 14M-55	18F	2517	34	151.52	148.79	160	–	70	45	12.5
TB36 14M-55	18F	2517	36	160.43	157.68	168	–	70	45	12.5
TB38 14M-55	18F	2517	38	169.34	166.60	183	–	70	45	12.5
TB40 14M-55	18F	2517	40	178.25	175.49	188	–	70	45	12.5
TB44 14M-55	18F	3020	44	196.08	193.28	211	–	70	51	9.5
TB48 14M-55	18F	3020	48	213.90	211.11	226	–	70	51	9.5
TB56 14M-55	18F	3020	56	249.55	246.76	256	170	70	51	9.5
TB64 14M-55	19F	3020	64	285.21	282.41	296	170	70	51	9.5
TB72 14M-55	19	3020	72	320.86	318.06	–	170	70	51	9.5
TB80 14M-55	20	3020	80	356.51	353.71	–	170	70	51	9.5
TB90 14M-55	20	3020	90	401.07	398.28	–	170	70	51	9.5
TB112 14M-55	20	3020	112	499.11	496.32	–	170	70	51	9.5
TB144 14M-55	20	3020	144	641.71	638.92	–	170	70	51	9.5
TB168 14M-55	20	3020	168	748.66	745.87	–	170	70	51	9.5
TB192 14M-55	20	3020	192	855.62	852.82	–	170	70	51	9.5

14M-85

for belt width 85mm

Pulleys with taper bushed bore

Part No.	Type	Bush	Z	Dp	De	Df	Dm	F	L	R
TB28 14M-85	18F	2517	28	124.78	122.12	127	–	102	45	28.5
TB30 14M-85	18F	2517	30	133.69	130.99	138	–	102	45	28.5
TB32 14M-85	18F	2517	32	142.60	139.88	154	–	102	45	28.5
TB34 14M-85	18F	2517	34	151.52	148.79	160	–	102	45	28.5
TB36 14M-85	18F	3020	36	160.43	157.68	168	–	102	51	25.5
TB38 14M-85	18F	3020	38	169.34	166.60	183	–	102	51	25.5
TB40 14M-85	18F	3020	40	178.25	175.49	188	–	102	51	25.5
TB44 14M-85	18F	3020	44	196.08	193.28	211	–	102	76	13
TB48 14M-85	18F	3020	48	213.90	211.11	226	–	102	76	13
TB56 14M-85	18F	3525	56	249.55	246.76	256	190	102	65	18.5
TB64 14M-85	19F	3525	64	285.21	282.41	296	190	102	65	18.5
TB72 14M-85	19	3525	72	320.86	318.06	–	190	102	65	18.5
TB80 14M-85	20	3525	80	356.51	353.71	–	190	102	65	18.5
TB90 14M-85	20	3525	90	401.07	398.28	–	190	102	65	18.5
TB112 14M-85	20	3525	112	499.11	496.32	–	190	102	65	18.5
TB144 14M-85	20	3525	144	641.71	638.92	–	190	102	65	18.5
TB168 14M-85	20	3525	168	748.66	745.87	–	190	102	65	18.5
TB192 14M-85	22	4040	192	855.62	852.82	–	230	102	102	–

14M-115

for belt width 115mm

Pulleys with taper bushed bore

Part No.	Type	Bush	Z	Dp	De	Df	Dm	F	L	R
TB28 14M-115	18F	2517	28	124.78	122.12	127	–	133	45	44
TB30 14M-115	18F	2517	30	133.69	130.99	138	–	133	45	44
TB32 14M-115	18F	2517	32	142.60	139.88	154	–	133	45	44
TB34 14M-115	18F	2517	34	151.52	148.79	160	–	133	45	44
TB36 14M-115	18F	3020	36	160.43	157.68	168	–	133	51	41
TB38 14M-115	18F	3020	38	169.34	166.60	183	–	133	51	41
TB40 14M-115	18F	3020	40	178.25	175.49	188	–	133	51	41
TB44 14M-115	18F	3020	44	196.08	193.28	211	–	133	76	28.5
TB48 14M-115	18F	3020	48	213.90	211.11	226	–	133	76	28.5
TB56 14M-115	18F	3535	56	249.55	246.76	256	190	133	89	22
TB64 14M-115	19F	3535	64	285.21	282.41	296	190	133	89	22
TB72 14M-115	19	3535	72	320.86	318.06	–	190	133	89	22
TB80 14M-115	20	3535	80	356.51	353.71	–	190	133	89	22
TB90 14M-115	20	3535	90	401.07	398.28	–	190	133	89	22
TB112 14M-115	20	3535	112	499.11	496.32	–	190	133	89	22
TB144 14M-115	20	4040	144	641.71	638.92	–	230	133	102	15.5
TB168 14M-115	20	4040	168	748.66	745.87	–	230	133	102	15.5
TB192 14M-115	20	4040	192	855.62	852.82	–	230	133	102	15.5